

RESEARCH

THE THIRD EXIS

PROBLEMS



The **starting** point of this project is the **bad situation** of the **refugee'** s living.

Because of the **high cost** of **accommodating** them, it become a great **problem**.



Then I **alter** it into the living **problem** of the **rover** in my city since we do **not have** the **refugee** issue.

They are **homeless** and completely out of the **modern society** system.

BASIC CONCEPT



The structure I want to add.

Buildings

The zone people act

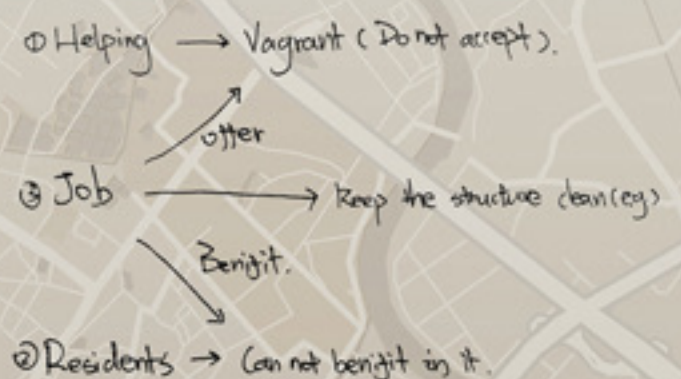

DEVELOP

THE THIRD EXIS

LOCATION



I done a **research** about the **location**: a **park** in an **urban village**.

I wanna set the park as the **point** which structures **spread out**. Also I want to keep the original form.

BASIC FORM



I done a **location model** to analyze the **detail** of the **site**.

Then, I **combined** the plan and the **model** and create the basic **structure** of the **architecture**.

IMPROVEMENT

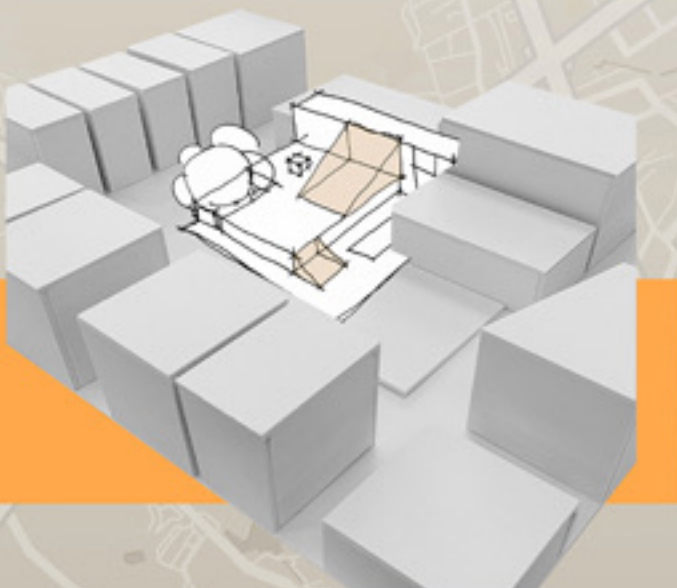

I extract **carboard** as a **factor** to design the **architecture** and use the **similar material** to design the walls.

FINAL

THE THIRD EXIS

RENDER



I modeled the architecture with using sketchup.

Then I done a collage render in photoshop to shows the sense of the reality.

STRUCTURE



After I design the details and some statistics of the architecture, I model it with using sketchup.

Here are the explosion view of the architecture.

Here are some different view of the architecture, including the iso view and the top view of the whole structre with the form itself and the surrounding.